



OLDS

*Distinguished Brasses*

# OLDS

*D I S T I N G U I S H E D B R A S S E S*

---

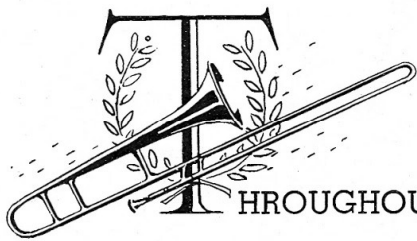

**T**HROUGHOUT two generations the brass instruments of F. E. Olds & Son have been accorded the distinction of leadership in their industry. Their brilliance of tone has always been complemented by a graceful simplicity of design and delicacy of balance that has endeared them to discriminating musicians. Flawless workmanship of exquisite detail completes their irresistible appeal. To play an Olds is to insure alike the commendation of fellow musicians and listeners.

---

OLDS  
*Distinguished* BRASSES

**TRADITION** inspires the craftsmen who fashion Olds Brasses . . . master workmen who take pride in their handwork, in the important part they play in carrying on the long-established supremacy of Olds Brasses . . .

**MATERIALS** of meticulous selection contribute to the refined excellence of the Olds. Eleven separate brass and nickel alloys are used . . . each one made especially for Olds to an exacting formula held to specifications ordinarily reserved for laboratory work . . .

**TONAL PURITY** in the Olds is the glorious result of infinite care in every detail of construction and years of experimental development in acoustical physics. These have achieved for Olds a musical scale of unequalled correctness . . . tone quality rich in the harmonious over-tones of a perfect musical instrument . . .

**MODERN GRACE** in the styling of every Olds is made possible by its basic perfection from the acoustical conception through its painstaking hand construction to its brilliant performance in the hands of the deserving artist.



## OLDS Standard TROMBONE

A hand made, custom-built trombone, embodying the original F. E. Olds continuous, delicately tapered bell. This outstanding trombone has, for more than a generation, been the undisputed choice where perfection of intonation and workmanship are demanded. The tuning slide is in the slide, leaving the bell portion one uninterrupted and continuous taper, eliminating any possibility of wolf tone or bad intonation.

For players who need hairline tuning, evenly balanced intonation and extreme flexibility, this model knows no equal.

### Bores

#### 7-in. Bell, Medium (M-7)

A particularly brilliant instrument suitable for general use.

#### 7-in. Bell, Large Med. (LM-7)

A fuller, more resonant tone for modern interpretations.

#### 7½-in. Bell, Large Med. (LM-7½)

The favorite all-around trombone where richness of tone, perfect balance of scale and volume are paramount.

#### 8-in. Bell, Large (L-8)

For heavy orchestra use, where extreme broad tone is desired.

Other sizes from 6-inch solo bells to bass trombones with F valve, made to special order.

### Finishes

Finish 1—Polished brass, braces and hand grips of nickel silver—neatly engraved. Supplied complete in artcraft case.

Finish 2—Heavily Silver Plated, satin finish braces and hand grips hand burnished. Bell gold lined, hand burnished—handsomely engraved. Supplied complete in artcraft case.

Finish 3—Quadruple Gold Plated, entire bell beautifully hand burnished and elaborately engraved, sides brush finish with burnished hand grips and points. Supplied complete in artcraft case.

Hand Hammered Bell on special order on any of the above instruments—Extra.

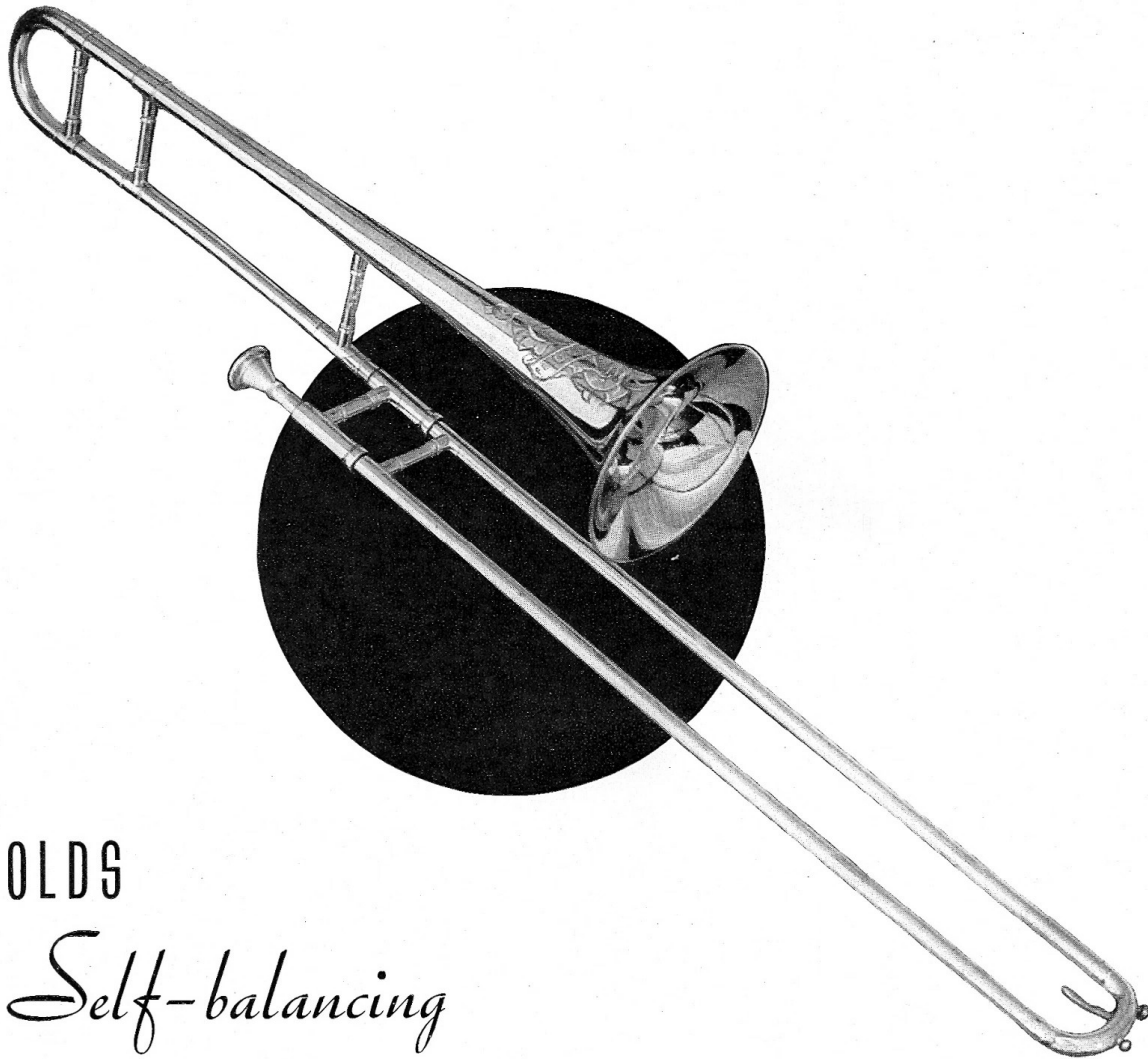

# OLDS

## *Self-balancing*

# TROMBONE

Made especially for musicians who have to meet the modern demand for long uninterrupted hours of playing. No outside balancer is needed as the weight in the bell section is adjusted to balance the horn perfectly at the grip. The tuning slide in the bell adds to the balance and makes lighter the slide action. The model is especially graceful and beautiful. As evidence of its acceptance we believe there are more Olds Self-Balancing models in use by fine musicians throughout the world than any other trombone.

### Bores

7-in. Bell, Medium (M-7)

A particularly brilliant instrument suitable for general use.

7-in. Bell, Large Med. (LM-7)

The larger throat gives a fuller, more resonant tone without detracting appreciably from the ease of playing.

7½-in. Bell, Large Med. (LM-7½)

Rich tone quality, powerful volume, ease of playing and balance in design are combined perfectly in this instrument for all-around playing.

8-in. Bell, Large (L-8)

For heavy orchestra use, where extremely broad tone is desired.

Other sizes from 6-inch solo bells to bass trombones with F valve, made to special order.

### Finishes

Finish 1—Polished Brass, braces and hand grips of nickel silver—neatly engraved. Supplied complete in artcraft case.

Finish 2—Heavily silver plated, satin finish, braces and hand grips hand burnished. Bell gold lined and hand burnished—handsomely engraved. Supplied complete in artcraft case.

Finish 3—Quadruple gold plated, entire bell beautifully hand burnished and elaborately engraved, slides brush finish with burnished hand grips and points. Supplied complete with artcraft case.

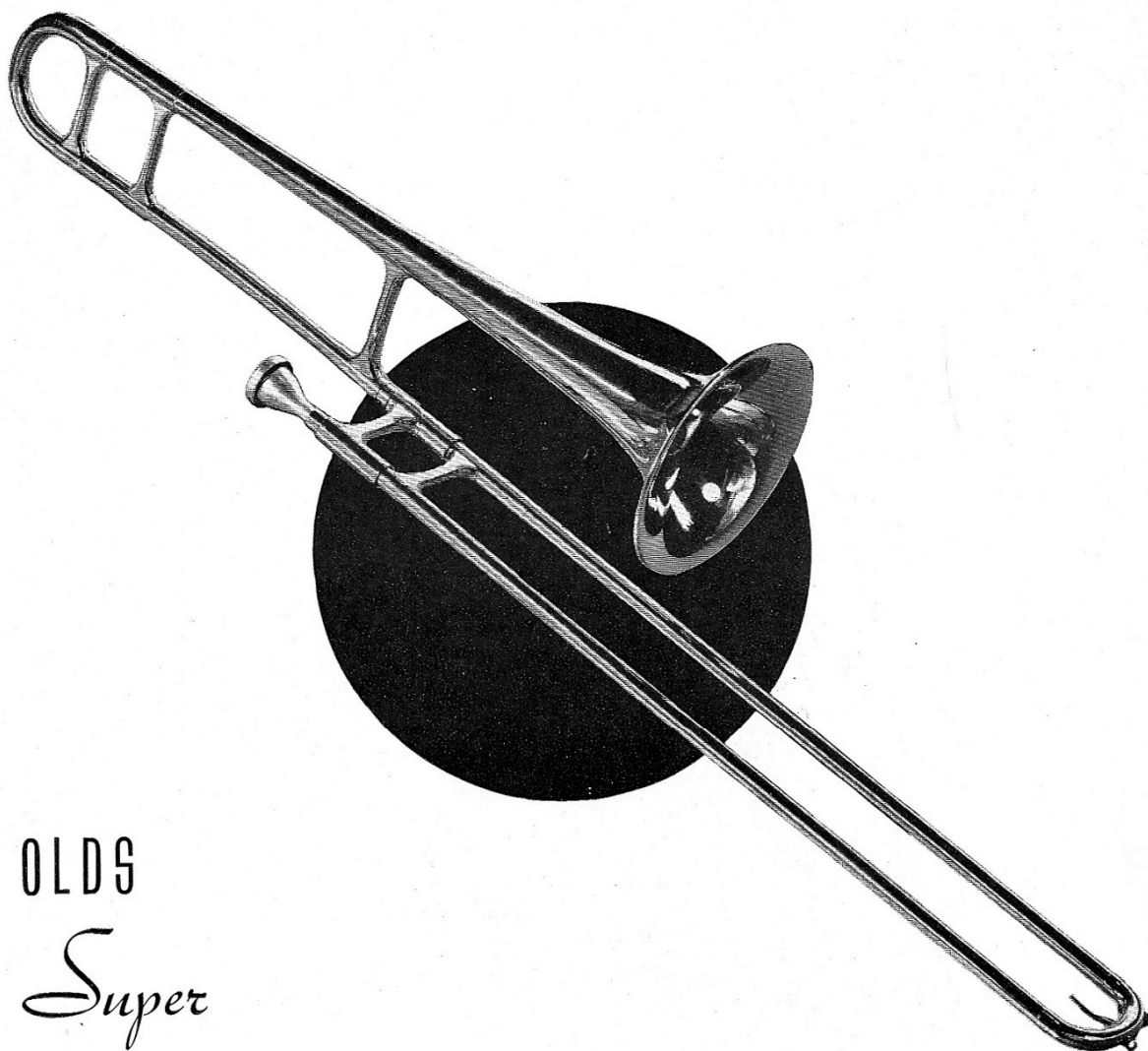

OLDS

*Super*

TROMBONE

Many points of superiority, in both musical quality and utility, are attained in the design of this exceptional instrument. A new voicing of a special richness in the upper register, with unusual solidity throughout the entire range, results from the improved taper of bore; the handsome, streamlined braces make the instrument unusually comfortable to hold, eliminating fatigue on a long job; the spun reinforcing band around the edge of the bell holds fortissimo power without blasting; unusually easy blowing throughout the entire register with the exact tuning and intonation for which Olds trombones have been noted throughout two generations. Made in one bore only, with choice of 7- or 7½-inch bell.



#### Finishes

- Finish 1—Polished brass, nickel silver trimmings, tuning slide braces, bell band and trimming all of finest and hardest nickel silver. Neatly engraved on bell band. Supplied regularly in gladstone type case with option of shaped case.
- Finish 2—Silver plated, satin finish, points highly burnished by hand. Bell gold lined and hand burnished. Supplied regularly in gladstone type case with option of shaped case.
- Finish 3—Quadruple gold plated, hand burnished. Handsomely engraved on bell band. Supplied regularly in gladstone type case with option of shaped case.

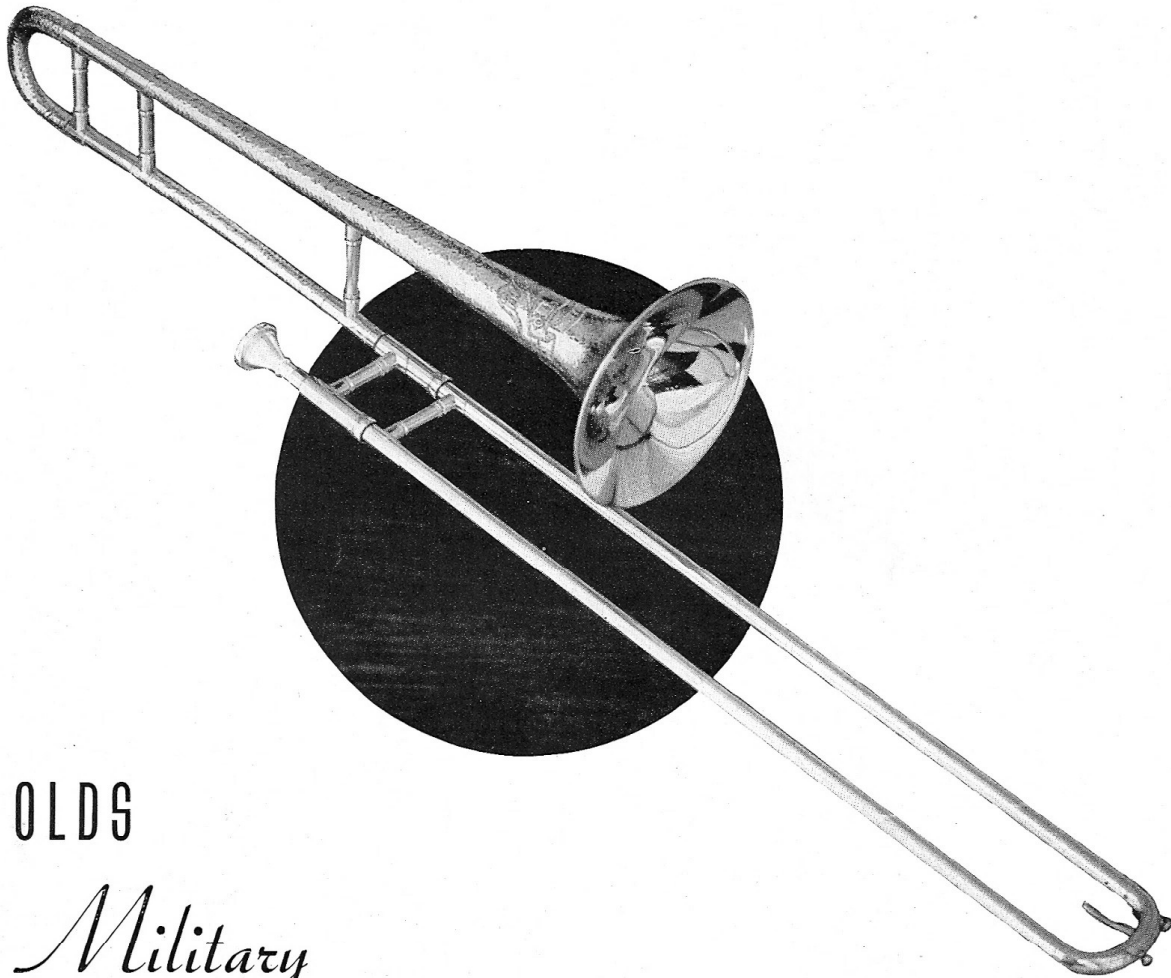

OLDS

*Military*

TROMBONE

An instrument with the exactness and precision of a Military Band and in a finish that dazzles the imagination. When playing this brilliant trombone, the remarkable ease of response and flexibility of tone are outstanding. The trim slides of a new "one-piece" design give modern speed and precise action. The sparkling hand hammered bell adds brilliance of appearance to match the unequalled Olds Tone.

#### *Bores*

6½ in. Bell, Small (S-6½)

A brilliant solo instrument, extremely light in attack, high resistance with unusually easily obtained high register.

7-in. Bell, Medium (M-7)

An all-around band and orchestra instrument of splendid proportions and flashy brilliance in tone and appearance.

7½ in. Bell, Large Medium (LM-7½)

A fuller, more resonant tone, for larger orchestras and heavy band work, particularly designed for large dance bands.

Other sizes from 6-inch solo bells to bass trombones with F valve, made to special order.

#### *Finishes*

Finish 1—Polished Brass with the dazzling hammered finish. Supplied complete in an artcraft case.

Finish 2—Heavily silver plated, satin finish, braces and hand grips hand burnished. Bell gold lined and hand burnished—handsomely engraved. Supplied with artcraft case.

Finish 3—Hand Burnished Gold on the dazzling hand-hammered finish. A sparkling instrument of extreme beauty. Supplied complete in artcraft case.

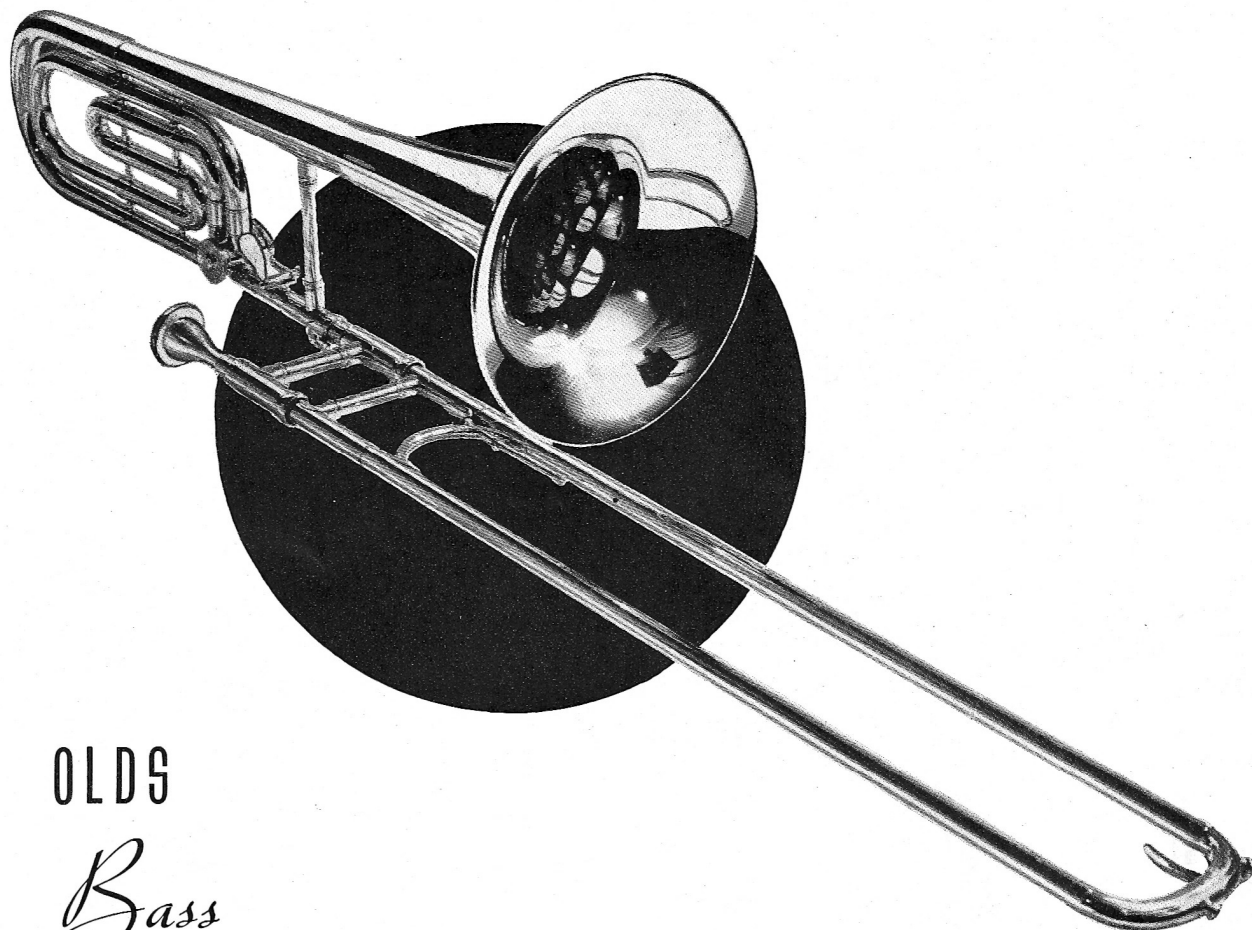

# OLDS

## *Bass*

# TROMBONES

For symphonic and large theater orchestra work a trombone with an additional rotary valve to F is customarily required, since the scoring of bass trombone parts quite often descends into the pedal registers which are not playable on the standard B $\flat$  slide trombone. For this work Olds has constructed a series of superfine instruments with bore and taper suitable for producing these extremely low registers, all metal rotary valves that operate easily and conveniently, with a rich, round tone throughout the unusually long range of the instrument. Those trombonists requiring B $\flat$  and F trombone will be agreeably delighted with the performance of these extraordinary instruments.

### Models and Bores

#### Tenor Model

B $\flat$  with rotary change to F, 8½ inch bell. A large medium instrument suitable for regular trombone passages extending up into the higher register, but with pedal tones of good intonation and volume.

#### Bass Model

Large bore with extra large symphonic taper of throat. 9-inch bell. Ideal for largest symphonic work; especially fine in lower register.

#### F and E Bass Model

This is the same instrument as the bass model listed above excepting that it is supplied with an additional rotary valve to E, and has a double trigger operating both valves, so that the full chromatic pedal register is instantly available.

### Finishes

#### Single Trigger Models in B $\flat$ and F

Finish 1—Polished brass, nickel silver trimming. Neatly engraved. Complete in Gladstone style case.

Finish 2—Heavily silver plated, satin finish, bell gold lined, hand burnished. Supplied complete in Gladstone style case.

Finish 3—Quadruple gold plated, handsomely engraved and hand burnished. Supplied in Gladstone style case.

#### Double Trigger Model—B $\flat$ F and E

Finish 1—Polished brass, nickel silver trimming. Complete in Gladstone style case.

Finish 2—Heavily silver plated, bell gold lined. Complete in Gladstone style case.

Finish 3—Quadruple gold plated, handsomely engraved and hand burnished. Supplied in Gladstone style case.





# OLDS

## *Standard*

# TRUMPET

A Supreme instrument, designed and constructed under the loving care of the "old school" craftsmen. An instrument in which the conical proportions are most carefully balanced to insure a perfect scale. That short, light, fast and enduring valve action of a new patented design lends speed and crispness to rapid passages called for in modern technique. The mechanical construction of the Olds is simple and sturdy and fits the hands so naturally as almost to become a part of the player.

### *Bores*

#### **Medium (M)**

A light, brilliant instrument of high resistance and brilliant tone.

#### **Large Medium (LM)**

Retaining the light playing qualities of the medium bore, but with a far more resonant tone. The popular choice, most suitable for all-around work.

#### **Large Large Medium (LLM)**

Medium bore through the tubing but with more generous throat than the LM, giving extremely broad quality of tone but retaining the light playing qualities. Splendid theater instrument.

### *Finishes*

**Finish 1—Polished Brass—Nickel Silver Trimming**  
—Tuning slide, braces and trimmings of the finest and hardest nickel silver. Neatly engraved by hand. Supplied complete in artcraft case.

**Finish 2—Heavily Silver Plated, satin finish,** points highly burnished by hand. Bell gold lined and hand burnished. Supplied complete in artcraft case.

**Finish 3—DeLuxe Burnished Gold—Quadruple gold plated—handsomely engraved and hand burnished.** A striking instrument of exquisite beauty for the connoisseur. Supplied complete in artcraft case.

Hand Hammered Bell on special order on any of the above instruments—Extra.



OLDS  
*Super*  
 TRUMPET

Every attribute of the superfine trumpet has been achieved—and surpassed—in this new product of Olds' genius. Extremely easy blowing, light weight, perfect balance, with a richness and depth of tone never before attained. The spun reinforcing band around the bell, the new proportions of bore and taper, the comfortable hand-hold, the exact balance and the new streamline design make it truly the realization of the fine players' ideals. Made only in the one special bore.



*Finishes*

- Finish 1—Polished brass, nickel silver trimmings, tuning slide braces, bell band and trimming all of finest and hardest nickel silver. Neatly engraved on bell band. Supplied regularly in Gladstone type case with the option of shaped case.
- Finish 2—Silver plated, satin finish, points highly burnished by hand. Bell gold lined and hand burnished. Supplied regularly in Gladstone type case with option of shaped case.
- Finish 3—Quadruple gold plated, hand burnished. Handsomely engraved on bell band. Supplied regularly in Gladstone type case with option of shaped case.

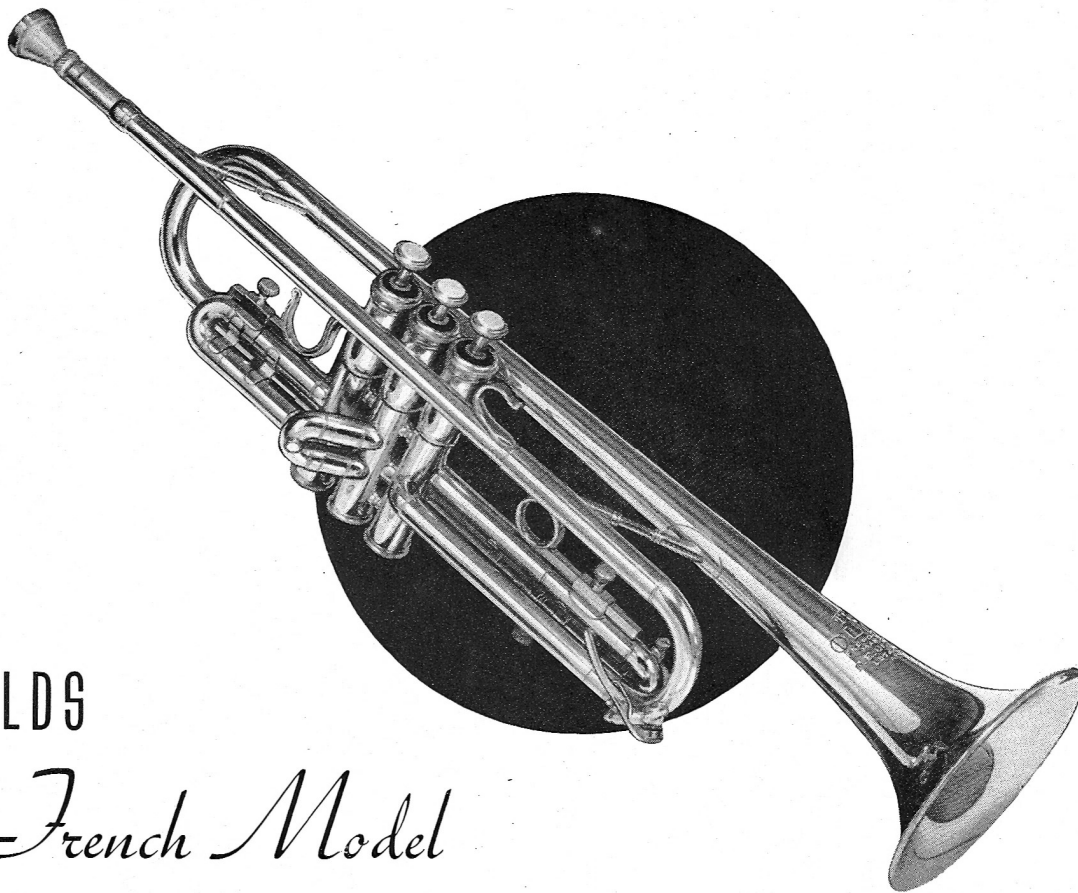

OLDS

*French Model*

TRUMPET

Relatively new in design and tonal character, this trumpet has become a great favorite within just a short time. Its brilliance and solidity of tone quality, positiveness of intonation and comfortable balance have made it the selection of many fine radio orchestra players.

*Bore*

Made in one size and bore only. The bore of the tubing is large medium. The throat is of generous size and the bell diameter is  $4\frac{3}{4}$  inches. Tuning slides on first and third valves, with adjustable rings for finger comfort, and adjustable for length of third valve slide throw. Built in B $\flat$  only—no adjustment mechanism for tuning to A, although tuning slide is long enough to pull to A-440 for the rare occasion when it is needed by the professional player.

*Finishes*

- Finish 1—Polished Brass—Nickel silver trimming—Tuning slide, braces and trimming of the finest and hardest nickel silver. Neatly engraver by hand. Supplied complete in artcraft case.
- Finish 2—Heavily Silver Plated, satin finish, points highly burnished by hand. Bell gold lined and hand burnished. Supplied complete in artcraft case.
- Finish 3—DeLuxe Burnished Gold—Quadruple gold plated—handsomely engraved and hand burnished. A striking instrument of exquisite beauty for the connoisseur. Supplied complete in artcraft case.

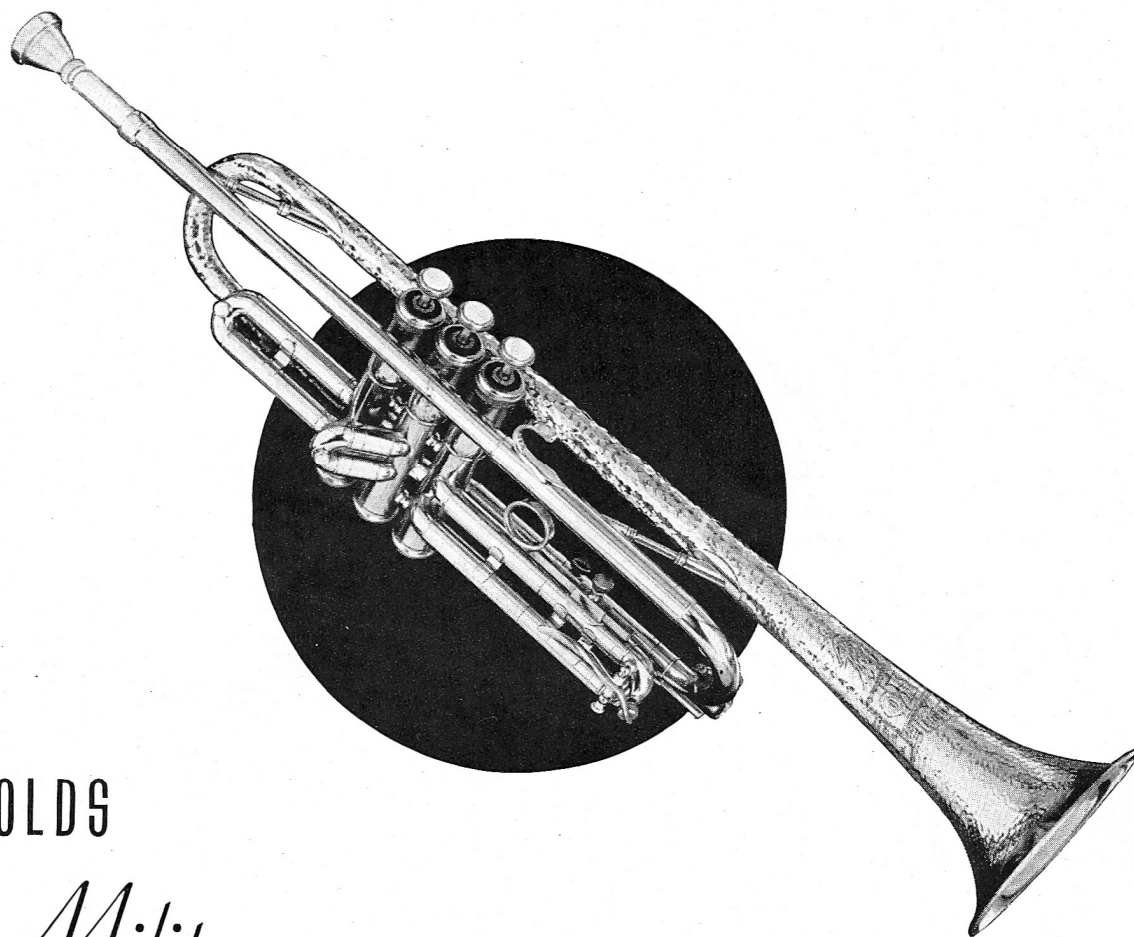

# OLDS

## *Military*

# TRUMPET

A brilliant toned instrument of spectacular appearance and performance. The hand-hammered bell of extremely modern design gives sparkling effect to the tone as well as making the instrument one of unusual beauty. The model is long and narrow and racy; it fits easily in the player's hand and balances perfectly. The combination of tone quality and beauty has made this model a favorite among modern artists.

### *Bores*

#### Small (S)

Extremely sensitive and brilliant. The high register particularly is very easy playing.

#### Medium (M)

Retaining in a great measure the light playing qualities of the small bore Military model, the medium bore has a considerably fuller and resonant tone. The popular choice, most suitable for all-around work.

#### Large Medium (LM)

Particularly desirable for large dance orchestra work where powerful volume and broadness of tone, combined with sparkling brilliancy and ease of playing, are needed.

### *Finishes*

Finish 1—Polished Brass—Nickel Silver Trimming—Tuning slide, braces and trimmings of the finest and hardest nickel silver. Neatly engraved by hand. Supplied complete in artcraft case.

Finish 2—Heavily Silver Plated, satin finish, points highly burnished by hand. Bell gold-lined and hand burnished. Supplied complete in artcraft case.

Finish 3—DeLuxe Burnished Gold—Quadruple gold plated, handsomely engraved and hand burnished. A striking instrument of exquisite beauty for the connoisseur. Supplied complete in artcraft case.

Can be supplied in plain bell model to special order.



OLDS

*Standard*

CORNET

A true leader with supreme breadth and flexibility of tone. A cornet with a full singing range and a tremendous power that places it immediately in the solo chair of the concert bands. For modern interpretations in popular and symphonic orchestration the Olds Cornet adds new life to the brass section and a thrill to the effect obtained. The mathematically proportioned, conical tapers of this cornet adds an unparalleled flexibility of tone to its correct scale.

*Bores*

Medium (M)

A particularly brilliant instrument with high playing qualities.

Large Medium (LM)

A cornet with colorful flexibility of tone. The popular choice, most suitable for all-around work.

Large (L)

A large instrument with tremendous weight and breadth of tone.

*Finishes*

Finish 1—Polished Brass—Nickel Silver Trimming—Tuning slide, braces and trimming of the finest and hardest nickel silver. Neatly engraved by hand. Supplied complete in artcraft case.

Finish 2—Heavily silver plated, satin finish, points highly burnished by hand. Bell gold lined and hand burnished. Supplied complete in artcraft case.

Finish 3—DeLuxe Burnished Gold—Quadruple gold plated—handsomely engraved and hand burnished. A striking instrument of exquisite beauty for the connoisseur. Supplied complete in artcraft case.

Hand hammered bell on special order on any of the above instruments—extra.



OLDS

*Super*

CORNET

The really expert player desires not only musical and mechanical excellence in his instrument but beauty of design with faultless workmanship must also be incorporated if he is to feel genuinely satisfied. In all these details the Super Olds Cornet excels. Its streamline form and bracing, the handsome spun band around the bell and its comfortable hand-hold match its rich tonal quality, ease of blowing, flexibility and fine intonation. It is a cornet for the player who wants the very best. Made only in the one special bore.



#### *Finishes*

- Finish 1—Polished brass, nickel silver trimmings, tuning slide braces, bell band and trimmings all of the finest and hardest nickel silver. Neatly engraved on bell band. Supplied regularly in Gladstone type case with option of shaped case.
- Finish 2—Silver plated, satin finish, points highly burnished by hand. Bell gold lined and hand burnished. Supplied regularly in Gladstone type case with option or shaped case.
- Finish 3—Quadruple gold plated, hand burnished, handsomely engraved on bell band. Supplied regularly in Gladstone type case with option of shaped case.



OLDS

*Military*

CORNET

Designed especially for those who prefer the voice of a cornet with the appearance and balance of a trumpet, this long, racy model instrument appeals to all classes of players. The hand hammered bell adds brilliancy of tone with dazzling beauty and the surprisingly light response and extreme flexibility of this model make it almost as easy playing as a trumpet, yet retaining the full beauty of the richer and less penetrating cornet tones.

#### Bores

##### Small (S)

Brilliant to the last degree, high resistance, extremely easy upper register, intonation perfectly balanced throughout the entire register. Marvelous instrument for the soloist.

##### Medium (M)

Just the right combination for general dance and popular orchestra work. Tone is rich and brilliant, the intonation very accurate and the balance right for long hours of playing.

##### Large Medium (LM)

A cornet with colorful flexibility of tone, richer and more sonorous, yet retaining a remarkably easy attack. Especially desirable for band work.

##### Large (L)

A large instrument of tremendous weight and breadth of tone.

#### Finishes

Finish 1—Polished Brass—Nickel Silver Trimming—Tuning slide, braces and trimmings of the finest and hardest nickel silver. Neatly engraved by hand. Supplied complete in artcraft case.

Finish 2—Heavily Silver Plated, satin finish, points highly burnished by hand. Bell gold lined and hand burnished. Supplied complete in artcraft case.

Finish 3—DeLuxe burnished gold—quadruple gold plated, handsomely engraved and hand burnished. A striking instrument of exquisite beauty for the connoisseur. Supplied complete in artcraft case.

Can be supplied in plain bell model to special order.

# Olds MOUTHPIECES

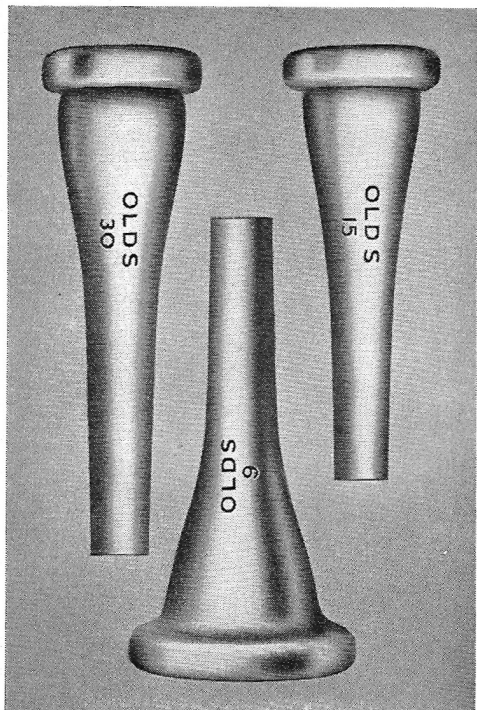

Olds mouthpieces represent the results of many years' experience in building special models. The collection listed below offers a style to fit every individual need. None is extreme or radical but all models are approved and have been tested carefully by fine professional players. Beautiful new streamline design, burnished silver plate finish.

#### Trumpet

- No. 18—Medium bore, with special muscle fitting rim, for extra rapid technique.
- No. 19—A high register mouthpiece with heavy tonal qualities.
- No. 20—For extreme high register, "hot-stomp" style.
- No. 21—Rounded cushion rim, medium bore, excellent for beginners.
- No. 22—Medium bore, for normal high register playing.
- No. 23—Medium large bore, for big orchestra work.
- No. 24—Wide, flat rim, for endurance playing and brilliance.
- No. 25—Medium shallow bore, brilliant, ideal for dance work.
- No. 26—Medium small, very fine for solo work.
- No. 27—Standard medium mouthpiece as furnished with Olds instruments.

#### Cornet

- No. 12—Medium bore, excellent for first chair band work.
- No. 13—Rather small, for extreme high register playing.
- No. 14—Concert style, splendid for soloist.
- No. 15—For big orchestra playing.
- No. 16—Shallow but of good tone, fine for band.
- No. 17—Medium bore, with special muscle fitting rim features, excellent for solo.

#### Trombone

- No. 7—For high register and solo playing.
- No. 8—Standard medium, as furnished with Olds instruments.
- No. 9—Special "long range" design, for featured players.
- No. 10—Medium bore with special muscle fitting rim for rapid technique.
- No. 11—Large bore, for big tone and heavy volume.

# Olds CASES



Easily the most outstanding and distinctive cases, recognized by musicians everywhere as the artistic containers of the world's finest instruments. Made of pressed fiber, practically indestructible, and extremely stiff and unyielding, they give the maximum protection to the instrument. Covered with high grade brown fabrikoid which can hardly be told from genuine leather, but is more resistant than genuine leather against scuffing and peeling. Oxidized hardware of modern design adds to the beauty. The shaped cases are French fitted to the instrument, with space for music lyre and mouthpieces. The gladstone style cases which are furnished regularly with Super Olds instruments, or at an additional charge of \$5.00 with the standard grade instruments, have ample room for a full assortment of mutes, in addition to other accessories.



# Olds REPLACEMENT PARTS

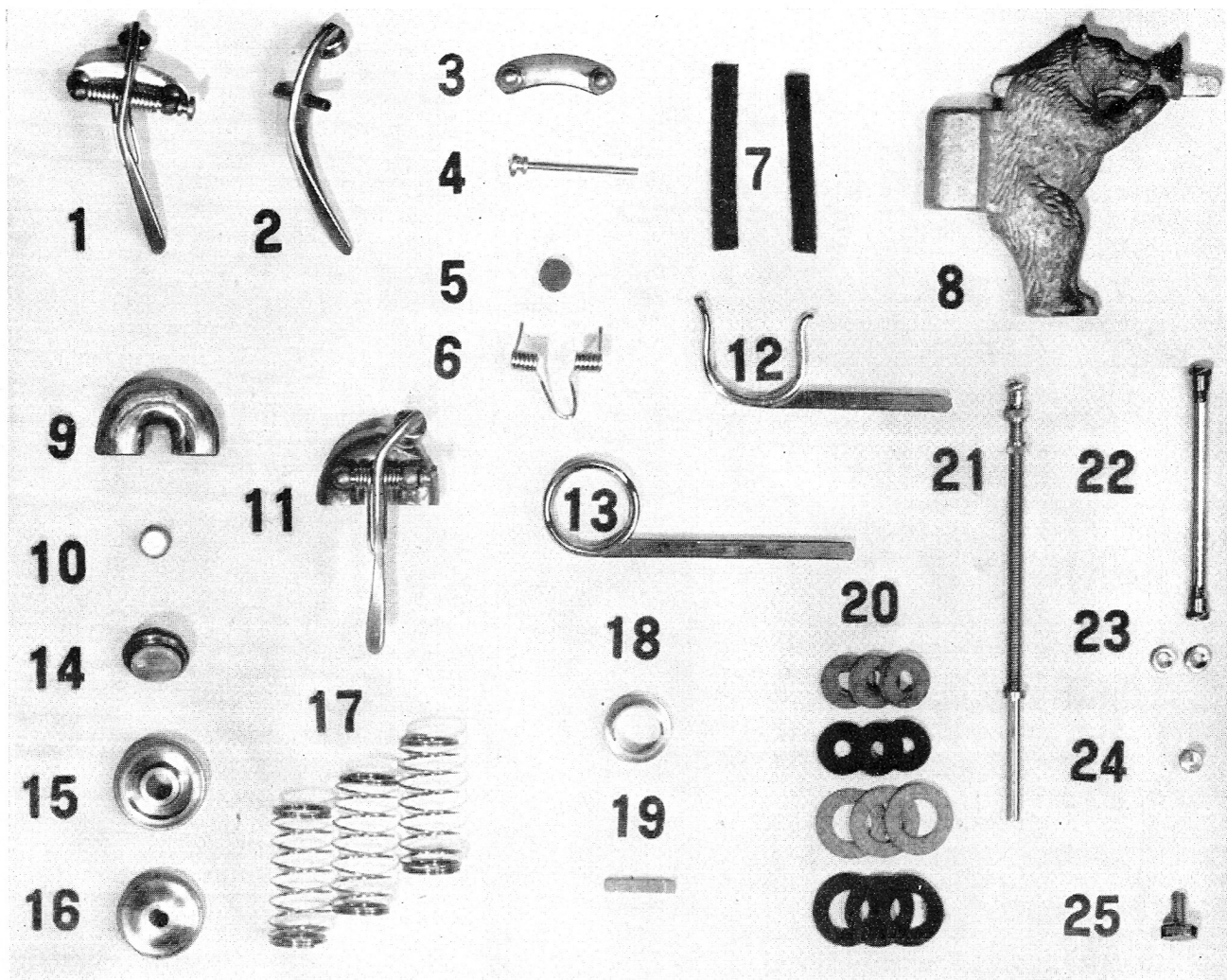

## Part No.

1. Water Key, complete assembly. Fits all instruments except valve slides.
2. Water Key Blank.
3. Water Key Hinge Plate.
4. Water Key Pin.
5. Water Key Pad.
6. Water Key Spring.
7. Trombone Slide Bumper, set of 2.
8. Trombone Counter Balance Weight.
9. Valve Slide Crook.
10. Valve Slide Pearl Knob.
11. Valve Slide Crook and waterkey assembly.
12. 1st Valve Thumb Rod.

## Part No.

13. 3rd Valve Ring Rod.
14. Pearl Finger Button.
15. Valve Top Cap.
16. Valve Button Caps.
17. Valve Springs, set of 3, balance.
18. Valve Guide Ring.
19. Valve Guide Pin.
20. Set Valve Corks and Felts.
21. A# Adjusting Rod Assembly.
22. C# Adjusting Rod Assembly.
23. A# Adjusting Rod Lock Nuts, pair.
24. Adjusting Rod End Nuts.
25. Thumb Screws.